

BROOKVIEW
a CONDOMINIUM
CONDO PT BK 12, PAGE 71
ZONED RM-12

N-F
KENNETH R JOHNSON
SARAH J ALLEN
DB 14849, PG 726
ZONED R-20

GENERAL RETAIL
FFE = 876.00 FT
AREA = 6,000 SQ.FT
HT = 35' MAX.
1214 MABLETON PKWAY

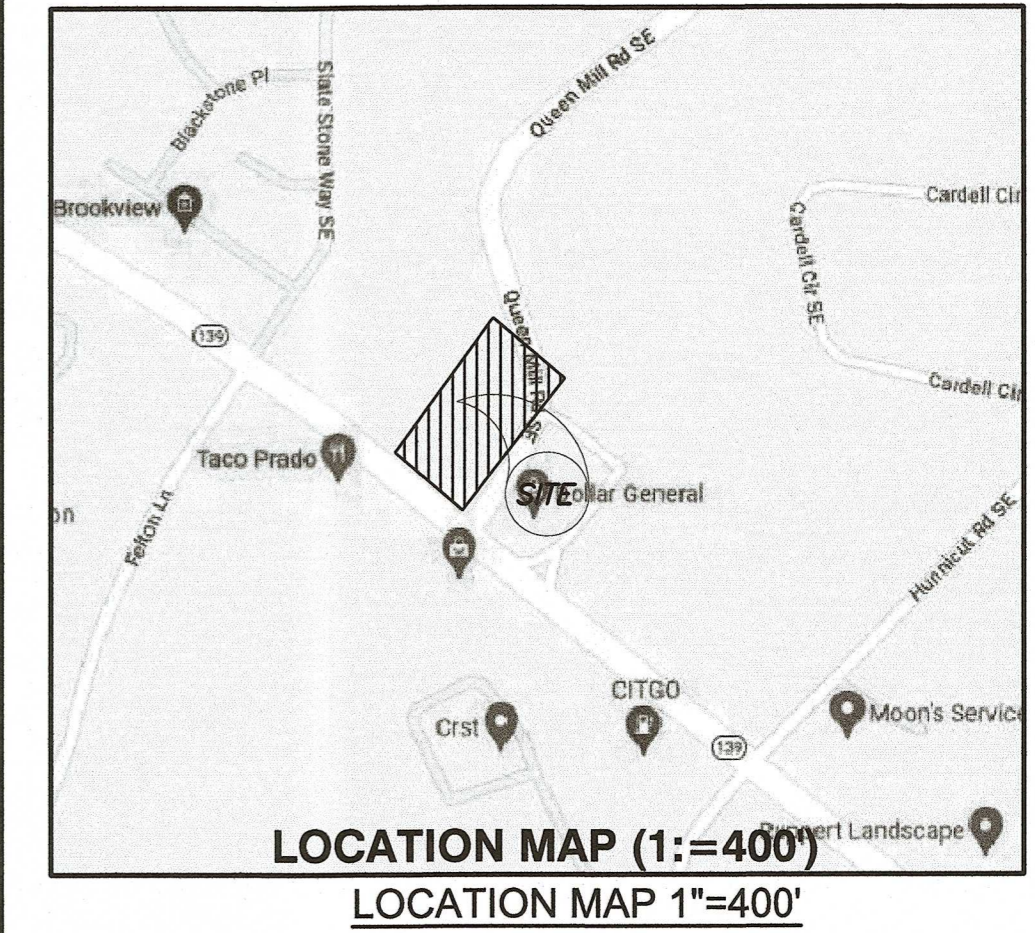

PROJECT NOTES:

DEVELOPER:
IMPACT WORSHIP CENTER
6925 Mableton Parkway SE
MABLETON, GEORGIA, 30126
PHONE: (904) 233-6818
CONTACT: Arthur Jones
EMAIL: arajones1970@aol.com

RECEIVED
JUN 01 2023
COBB COUNTY ZONING

ENGINEER:
KENTON GRIFFIN
GRIFFIN & DAVIS CONSULTING, INC.
6425 PEACHTREE PARKWAY,
SUITE 215
PEACHTREE CORNERS, GEORGIA 30092
PHONE: (678) 717-7814
FAX: (678) 251-7653
E-MAIL ADDRESS: john.taylor@griffin-davis.com

PROPERTY LOCATED IN L.L. 405, 406, 487, and 488, 18th DISTRICT, 2nd SECTION PARCEL # 18040800080 MABLETON, COBB COUNTY, GEORGIA.
CURRENT ZONING: GC & R-20 ; PROPOSED ZONING NRC

BUILDING SETBACKS REQUIREMENTS AND REQUESTS:
FRONT (ARTERIAL) - 50'
SIDE - 35'
REAR - 30'

PROPOSED USE IS GENERAL RETAIL USE

TOTAL TRACT CONTAINS 1.548 ACRES. DISTURBED AREA = 1.249 ACRES

THIS PROPERTY IS SHOWN ON F.I.R.M. PANEL NUMBER 13067C0216H, FOR UNINCORPORATED COBB COUNTY, GEORGIA DATED MARCH 04, 2013 AND IS NOT LOCATED WITHIN A SPECIAL FLOOD HAZARD ZONE.

BOUNDARY INFORMATION OBTAINED FROM LAND SYSTEMS, LLC (SURVEYING LAND SERVICES) DATED JANUARY 17, 2023.

AREA CALCULATIONS

GENERAL RETAIL	SITE AREA	1.548 ACRES
PROPOSED BUILDING AREA		6,000 SQ.FT

PARKING DATA

(RETAIL 1SP/200 SQ.FT)		
REQUIRED	30 SPACES	
PROVIDED	34 SPACES	
ACCESSIBLE SPACES PROVIDED	1 SP/1 VAN = 2 SPACES	
REQUIRED/PROVIDED	30 SPACES / 34 SPACES	

**24-HOUR EMERGENCY CONTACT:
ARTHUR JONES
(904) 233-6818**



IF YOU DIG GEORGIA...
CALL US FIRST!
1-800-282-7411
(770) 623-4344
(METRO ATLANTA ONLY)
UTILITIES PROTECTION CENTER
IT'S THE LAW

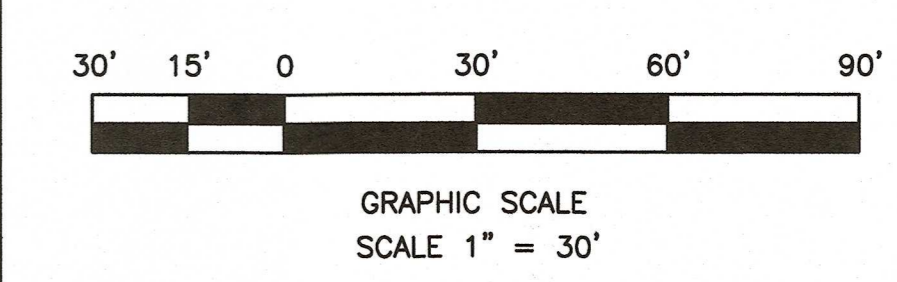

Griffin & Davis Consulting, Inc.
5425 Peachtree Parkway,
Suite 215
Norcross, GA 30092
Tel: (678) 717-7814 Fax: (678) 261-7653
www.griffin-davis.com 16 years

Civil Engineering Land Planning Landscape Architecture Transportation Services

Professional Engineer
KENTON G. GRIFFIN
No. 13150
05/31/2023
FIRM # PFE005016

General Retail
Developed by
Impact Worship Center
6925 Mableton Parkway Mableton, GA 30126

REVISION	DESCRIPTION
1.	

DATE: 01/23/2023

PROJECT No. IWC-001
DRAWN BY: JXT
CHECKED BY: LCO
DATE: 01-23-2023
Cobb County # TBD

General Retail
Parcel ID 18040800080
Mableton Parkway
Cobb County, GA

SHEET TITLE:
CONCEPT SITE

SHEET No. C-1